

SPECIFICATIONS

Current Rating: 2Amps
 Insulator Resistance: 5000Megohms min.
 Dielectric Withstanding: AC 500v
 Operating Temperature: -40° ~ +105° c
 Contact Material: Phorphos bronze
 Insulator Material: NY-6T
 Finish: Gold flash

UNSPECIFIED TOLERANCE: ±0.20

Dimensions list

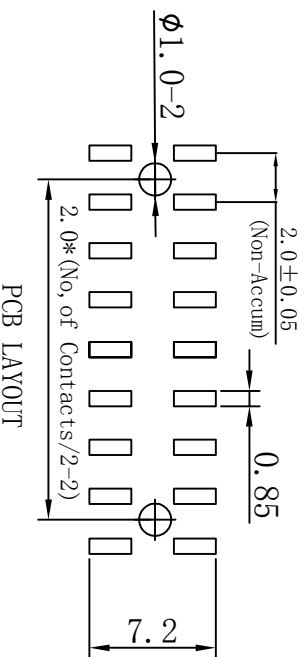
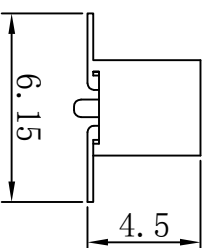
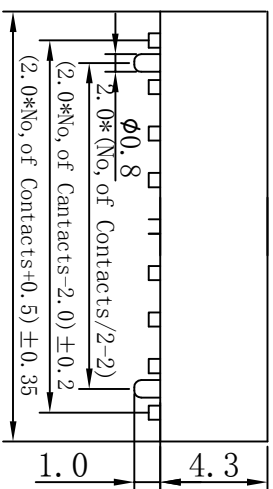
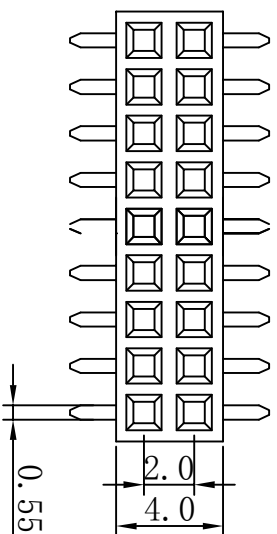

Contacts Per row	Dimensions		Contacts Per row	Dimensions	
	A	B		A	B
2*1	2.0	0	2*21	42.0	40.0
2*2	4.0	2.0	2*22	44.0	42.0
2*3	6.0	4.0	2*23	46.0	44.0
2*4	8.0	6.0	2*24	48.0	46.0
2*5	10.0	8.0	2*25	50.0	48.0
2*6	12.0	10.0	2*26	52.0	50.0
2*7	14.0	12.0	2*27	54.0	52.0
2*8	16.0	14.0	2*28	56.0	54.0
2*9	18.0	16.0	2*29	58.0	56.0
2*10	20.0	18.0	2*30	60.0	58.0
2*11	22.0	20.0	2*31	62.0	60.0
2*12	24.0	22.0	2*32	64.0	62.0
2*13	26.0	24.0	2*33	66.0	64.0
2*14	28.0	26.0	2*34	68.0	66.0
2*15	30.0	28.0	2*35	70.0	68.0
2*16	32.0	30.0	2*36	72.0	70.0
2*17	34.0	32.0	2*37	74.0	72.0
2*18	36.0	34.0	2*38	76.0	74.0
2*19	38.0	36.0	2*39	78.0	76.0
2*20	40.0	38.0	2*40	80.0	78.0

PH2.0*4.3 SMT 排母 带柱系列

Customer:	Approval:	Unit	Scale	Date
Drawing:	Check:	mm		05.10.22

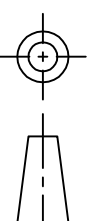

P/NO:
Pin Longger:
Signatuer:

深圳市永连旺电子有限公司